

# **GRACE CHURCH, SCARBOROUGH**

## ***HALL SET-UP DIAGRAMS***

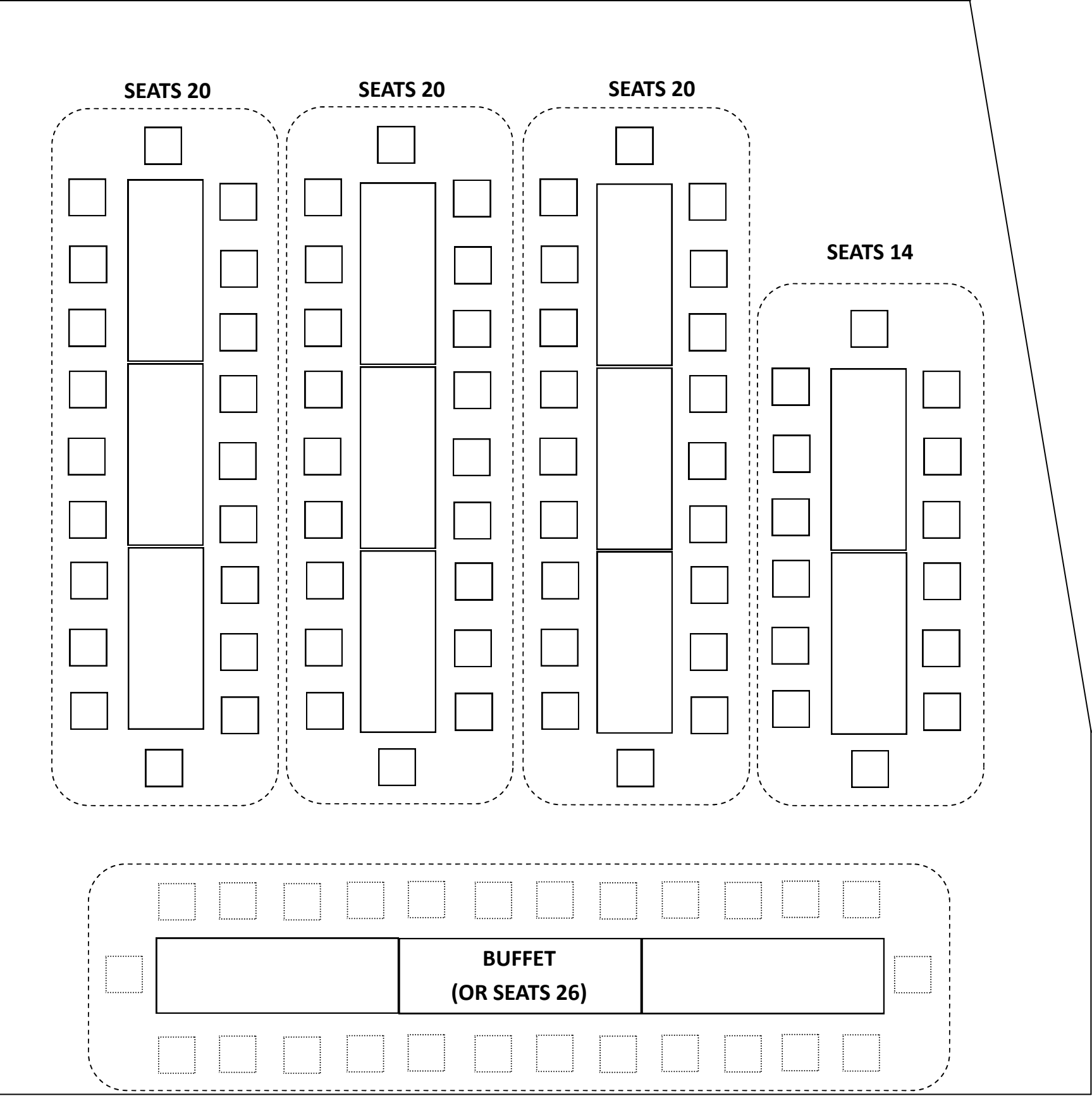

**LOWER HALL**  
**FORMAL DINING**  
**(MAX SEATING)**

*With Buffet:*  
**SEATS 74**

*Without Buffet:*  
**SEATS 100**

- Required:**
- 11- 30 x 72” tables
  - 74-100 blue cushion seats
  - 3 - 30 x 96” buffet tables

**LOWER HALL**  
**FORMAL DINING**  
**(COMFORTABLE SEATING)**

*With Buffet:*

**SEATS 60**

*Without Buffet:*

**SEATS 86**

**Required:**

9 - 30 x 72” tables

74-100 blue cushion seats

3 - 30 x 96” buffet tables

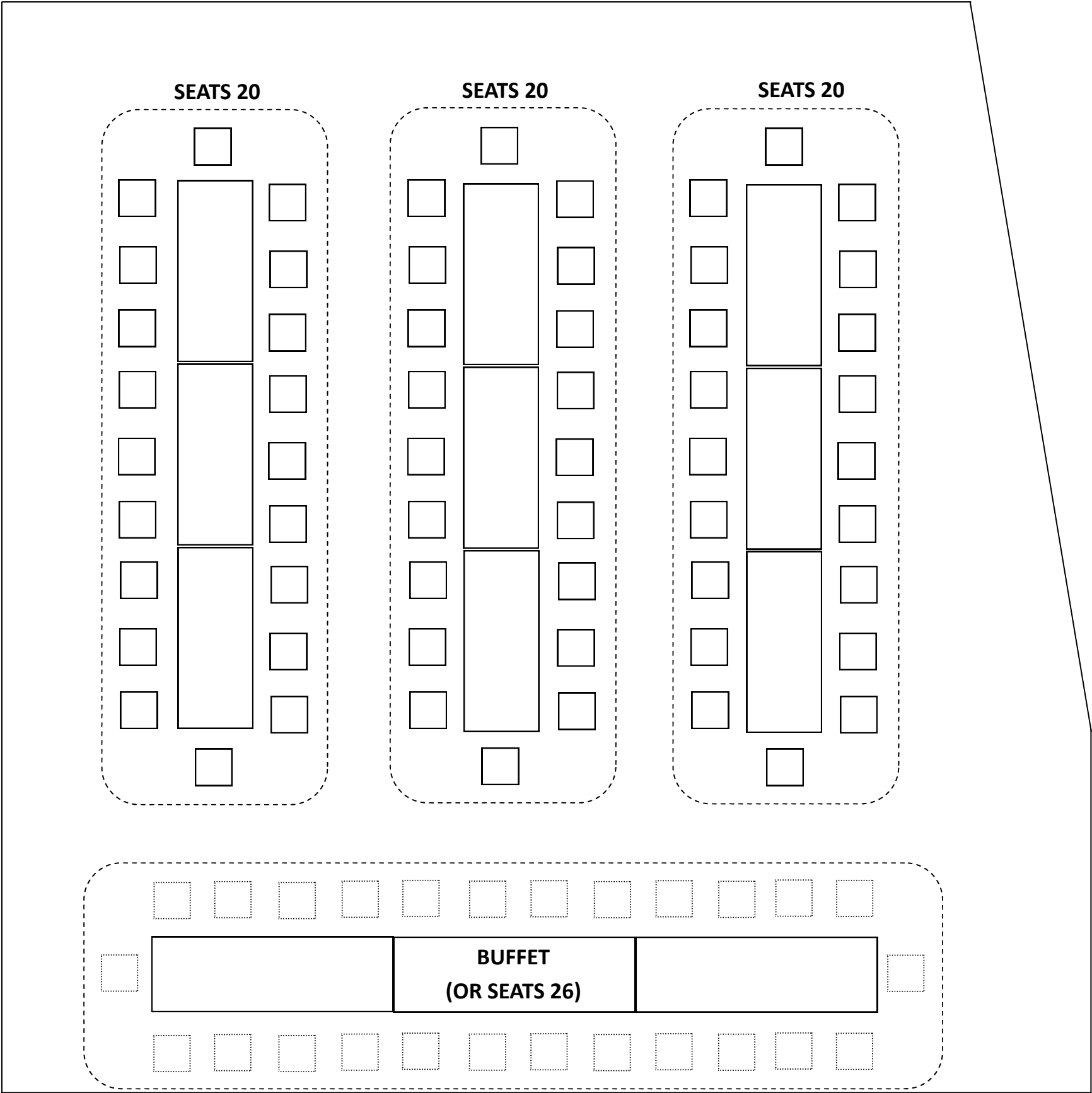

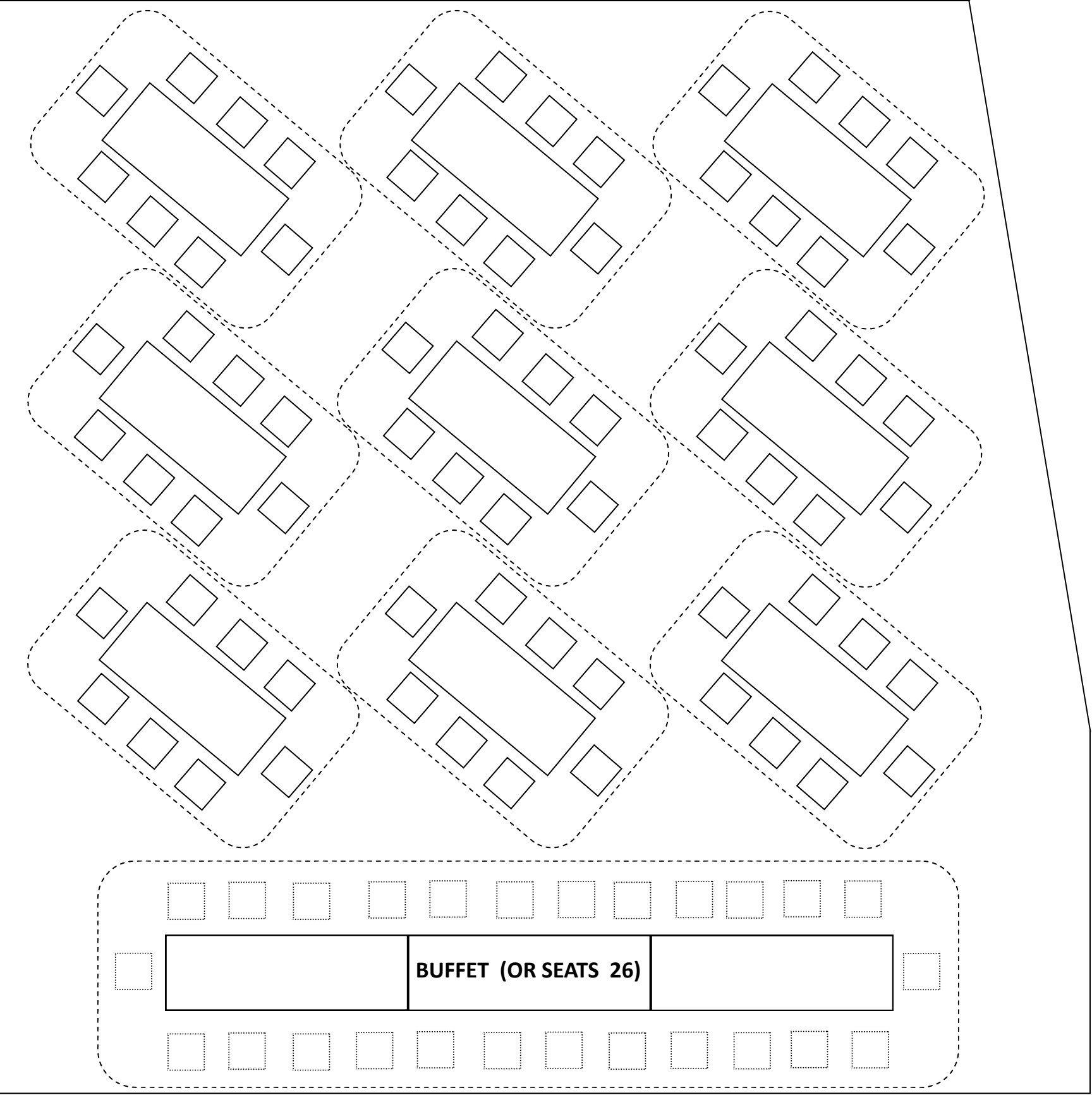

**LOWER HALL**  
**CASUAL DINING**  
**(MAX SEATING)**

*With Buffet:*  
**SEATS 72**

*Without Buffet:*  
**SEATS 98**

- Required:**
- 9- 30 x 72” tables
  - 72-98 blue cushion seats
  - 3 - 30 x 96” buffet tables

**LOWER HALL**  
**CASUAL DINING**  
**(COMFORTABLE SEATING)**

*With Buffet:*

**SEATS 48**

**Required:**

9- 30 x 72" tables

48 blue cushion seats

2 - 30 x 96" buffet tables

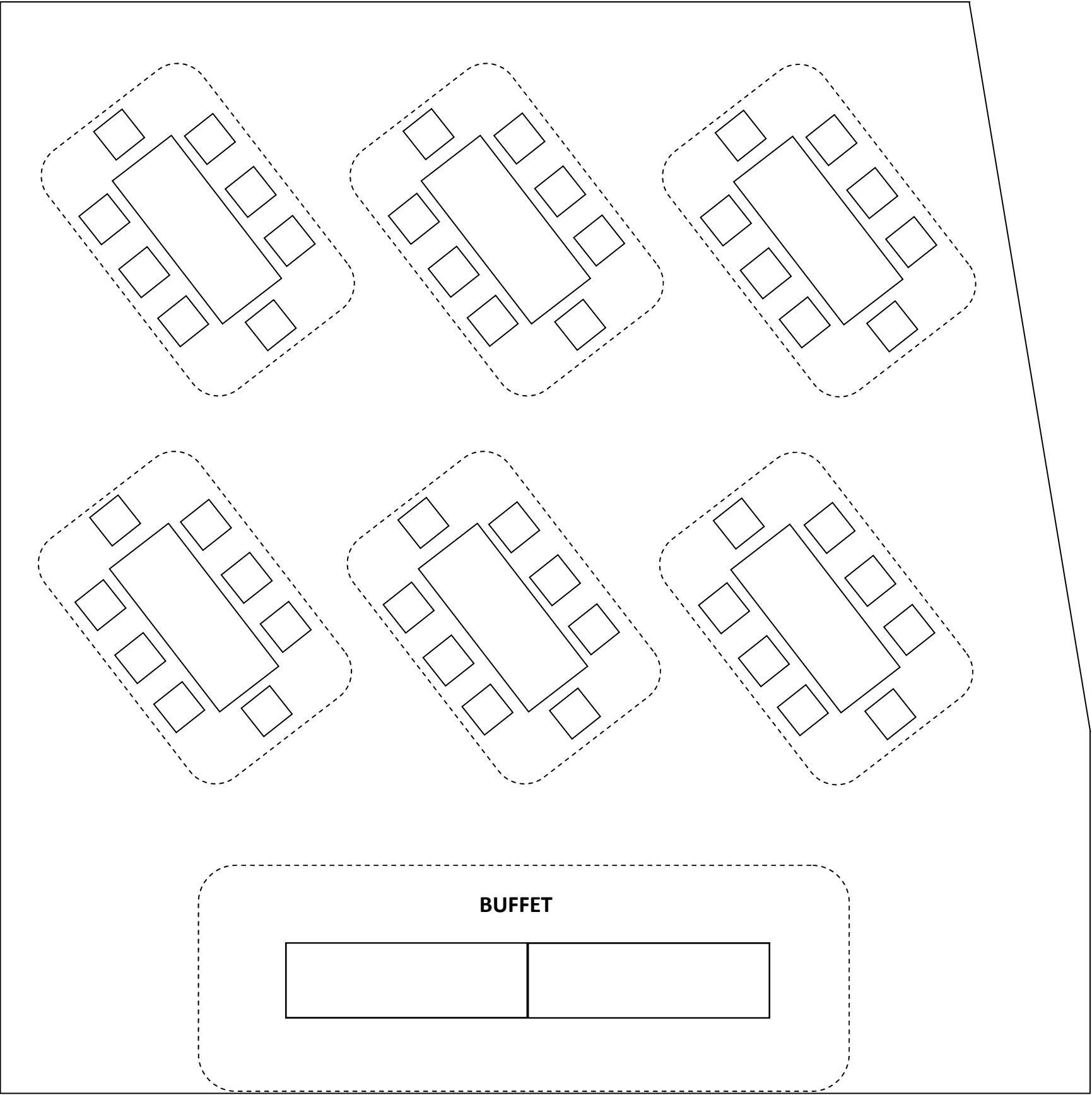

**LOWER HALL**  
**CASUAL DINING**  
**(COMFORTABLE SEATING)**

*Without Buffet:*

**SEATS 72**

**Required:**

9- 30 x 72" tables

72 blue cushion seats

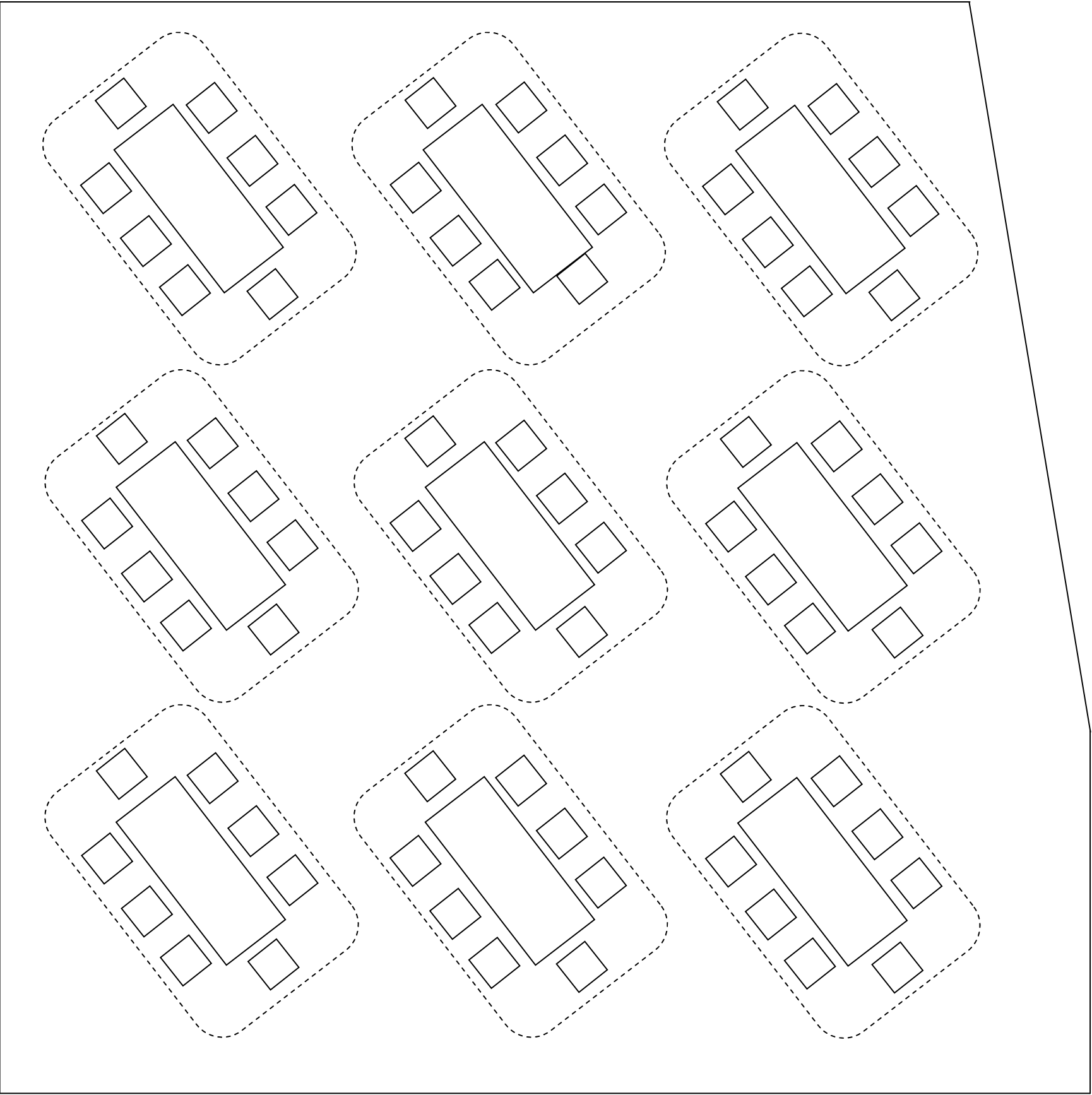

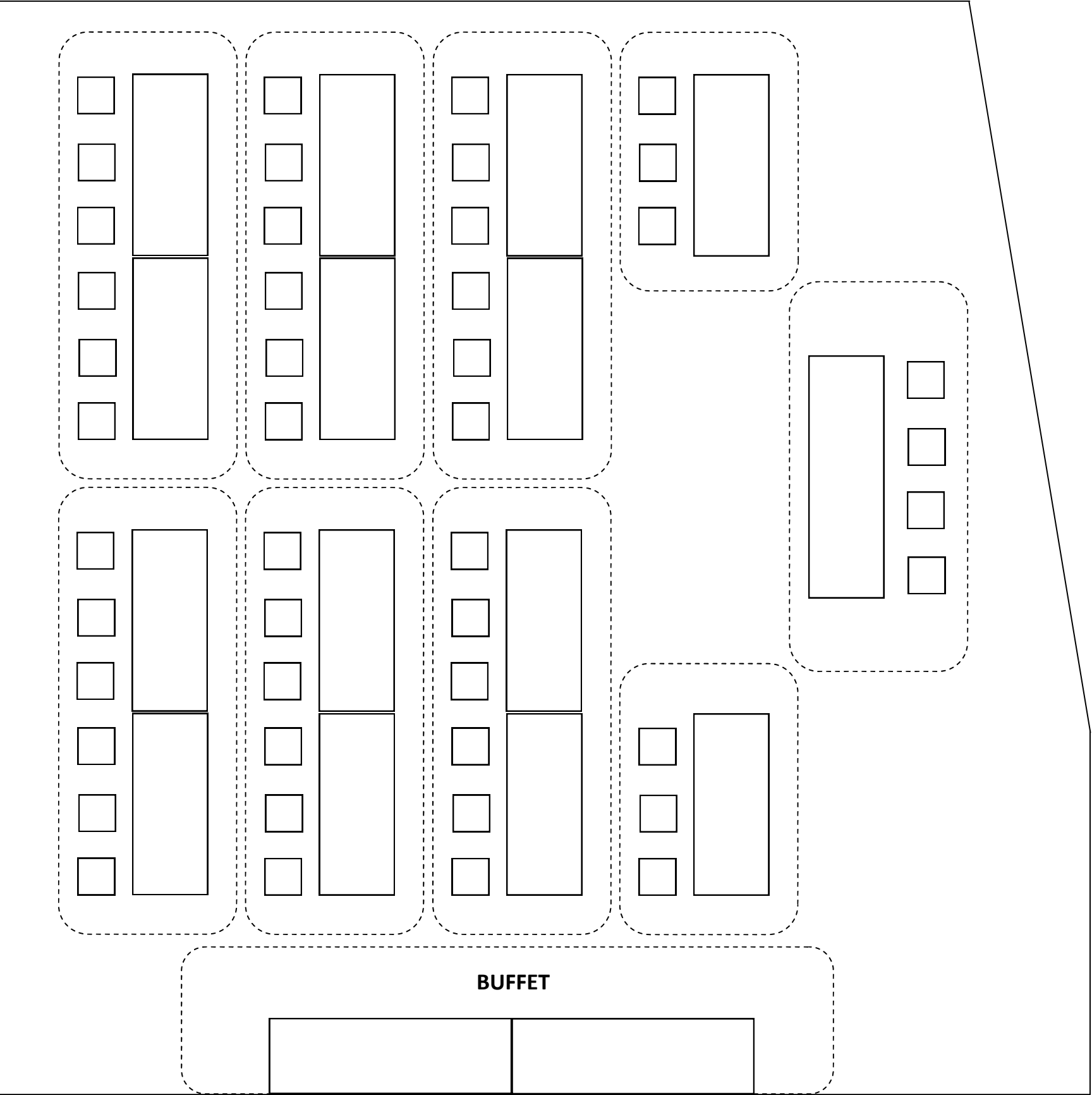

**LOWER HALL**  
**FORMAL SEMINAR/**  
**PRESENTATION**  
**WITH TABLES**  
**(MAX SEATING)**

Audience:  
SEATS 42

Presenters:  
SEATS 4

- Required:**
- 14 - 30 x 72" tables
  - 52 blue cushion seats
  - 3 - 30 x 96" buffet tables

**LOWER HALL**  
**FORMAL SEMINAR/**  
**PRESENTATION**  
**WITH TABLES**  
**(COMFORTABLE SEATING)**

Audience:  
SEATS 36

Presenters:  
SEATS 4

- Required:**
- 12 - 30 x 72" tables
  - 52 blue cushion seats
  - 2 - 30 x 96" buffet tables

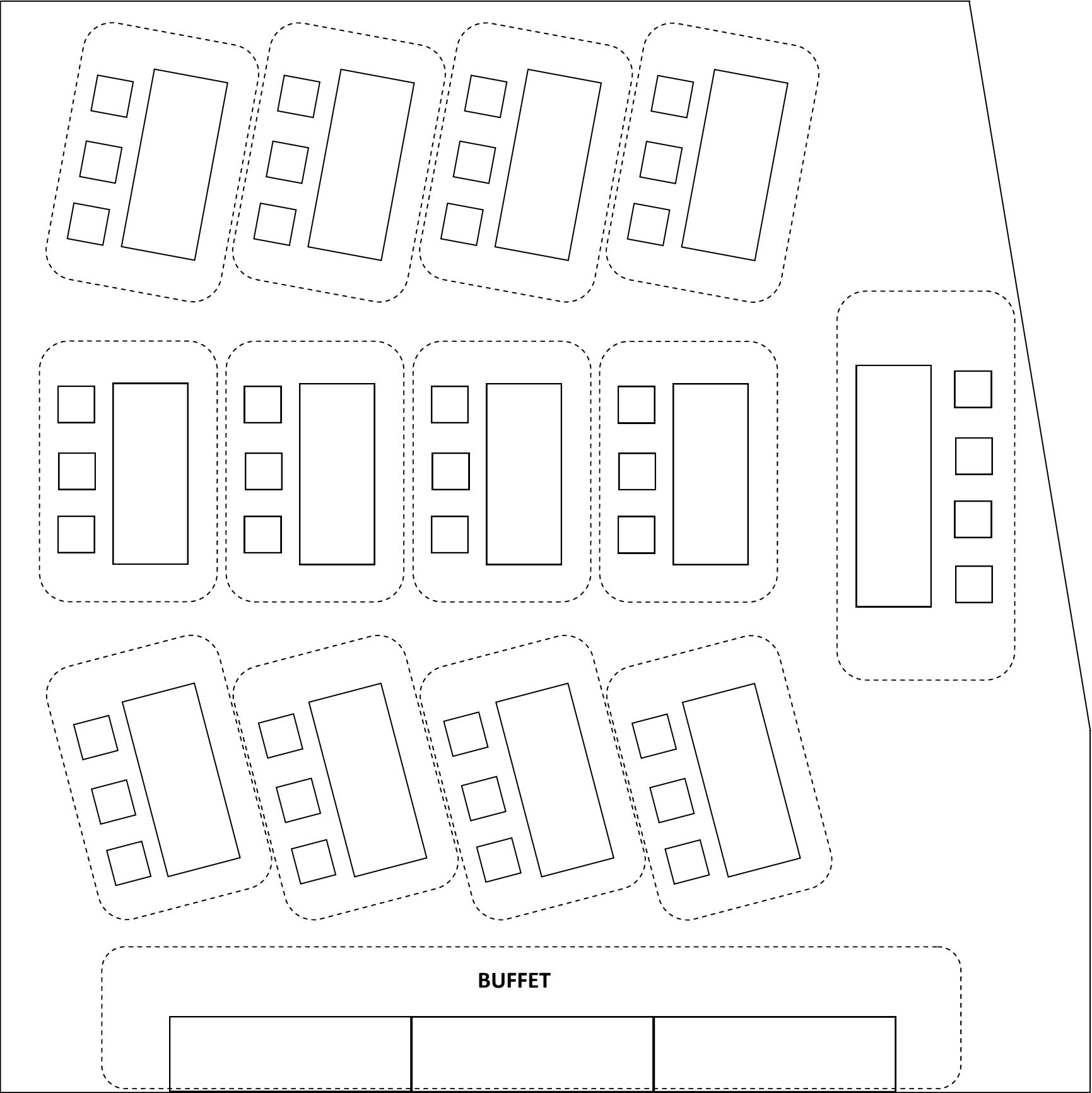



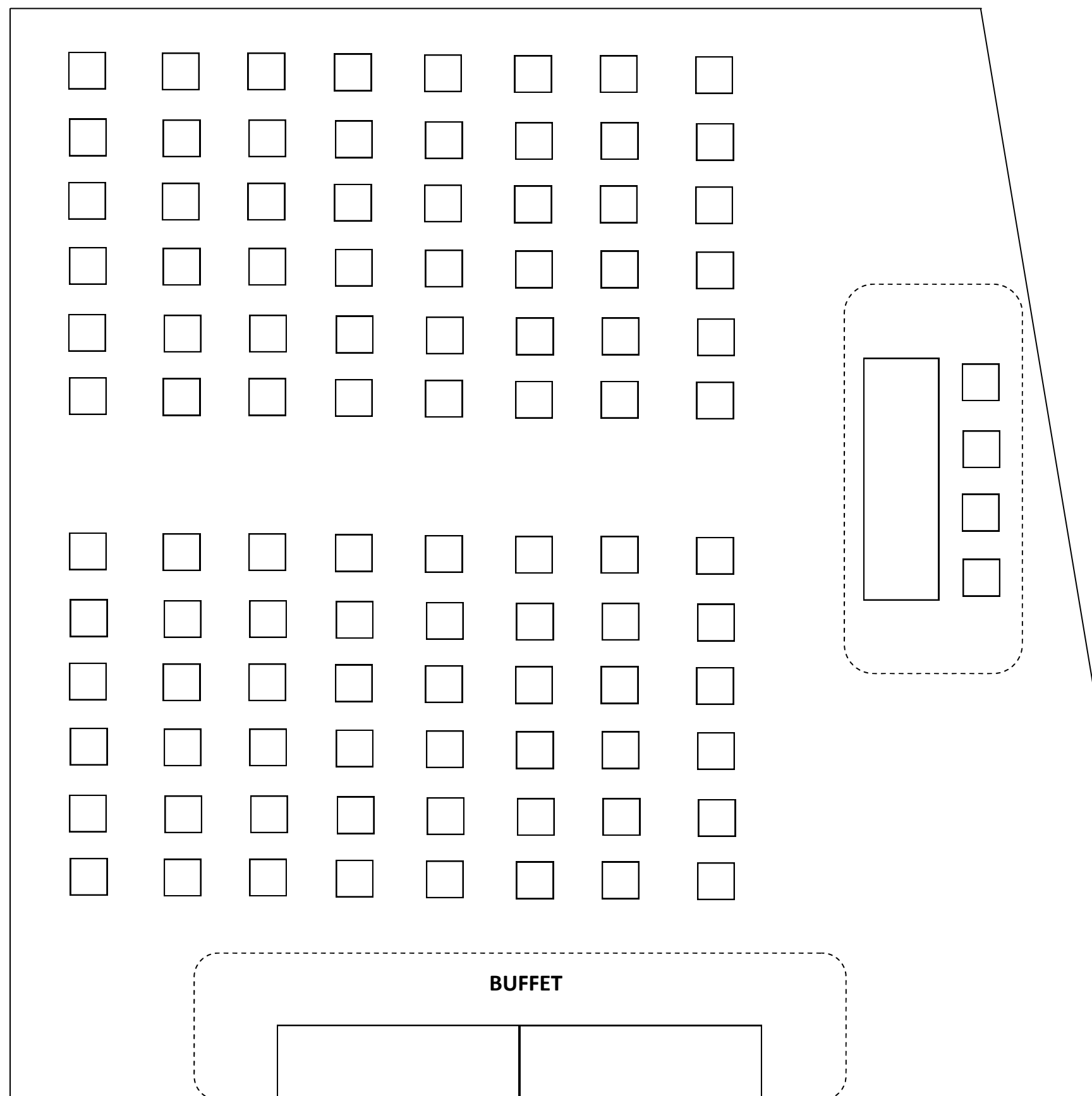

**LOWER HALL**  
**FORMAL SEMINAR/**  
**PRESENTATION**  
**(WITHOUT TABLES)**  
**(MAX SEATING)**

Audience:  
SEATS 96

Presenters:  
SEATS 4

**Required:**  
100 blue cushion seats  
2 - 30 x 96" buffet tables

**LOWER HALL**  
**SEMINAR/PRESENTATION**  
**(WITHOUT TABLES)**  
**(COMFORTABLE SEATING)**

Audience:  
SEATS 48

Presenters:  
SEATS 4

**Required:**  
52 blue cushion seats  
3 - 30 x 96” buffet tables

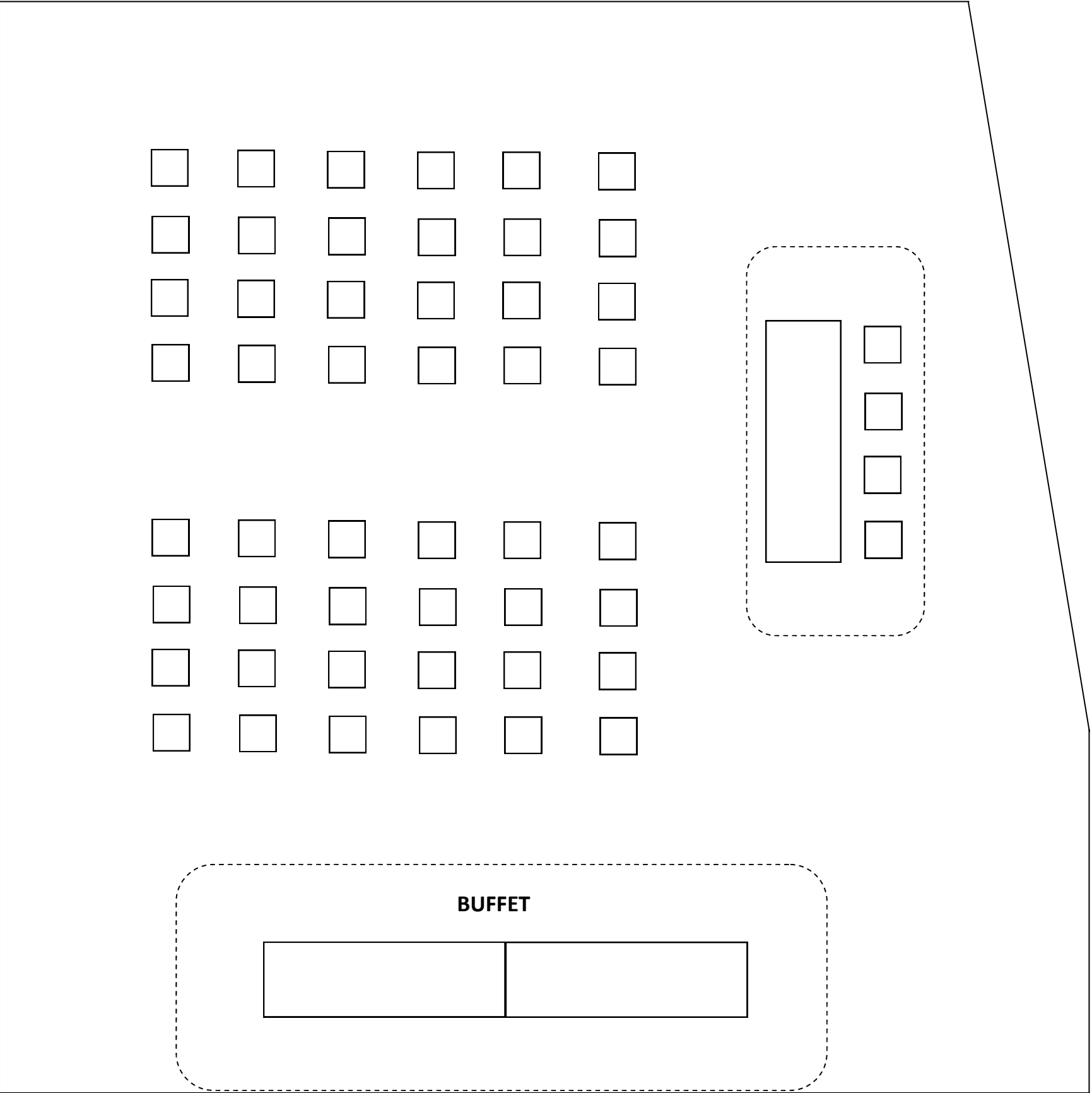

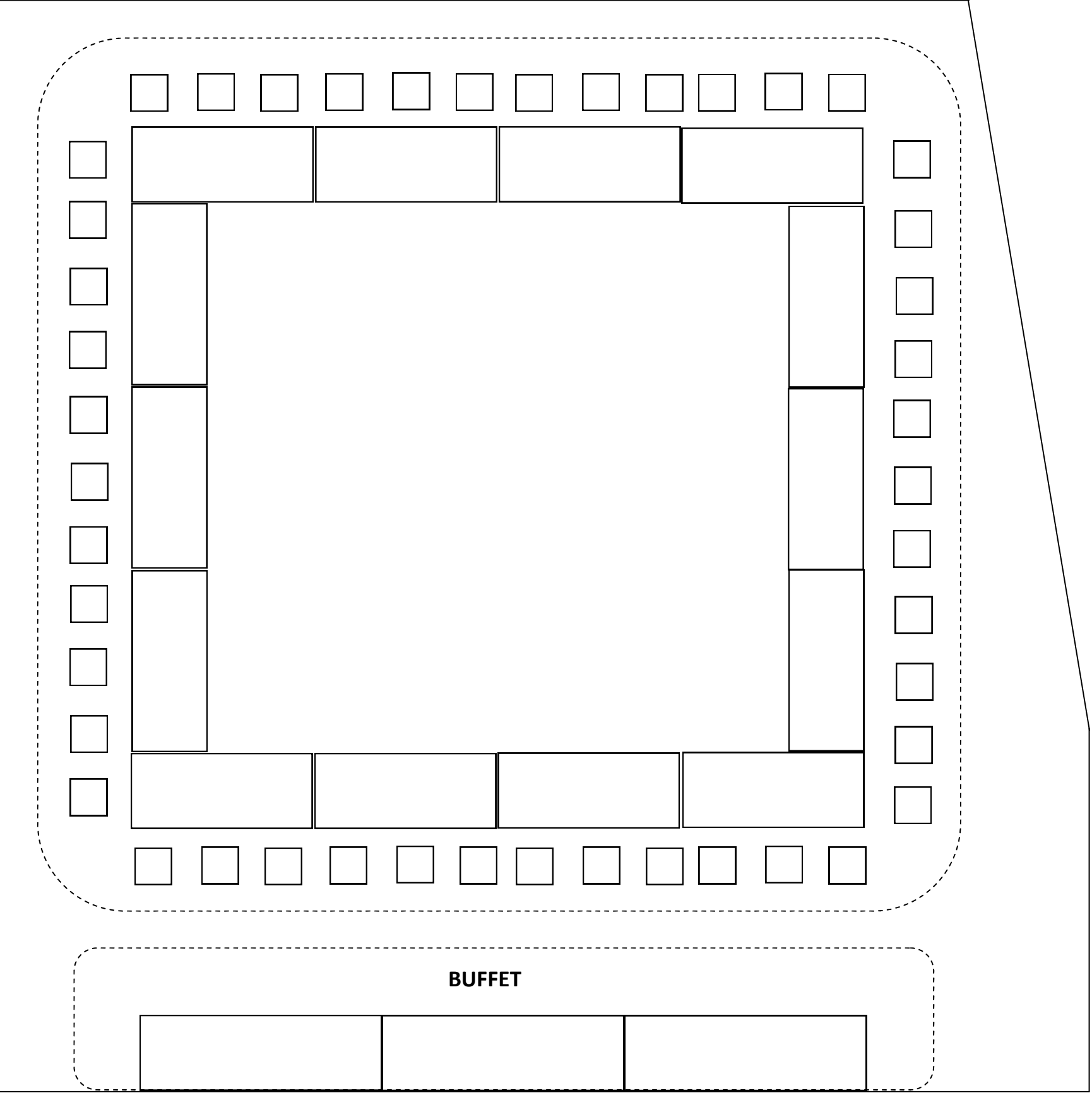

**LOWER HALL**  
**X-LARGE MEETING**

Audience:  
SEATS 46-56

- Required:**
- 14 - 30 x 72” tables
  - 46-56 blue cushion seats
  - 3 - 30 x 96” buffet tables

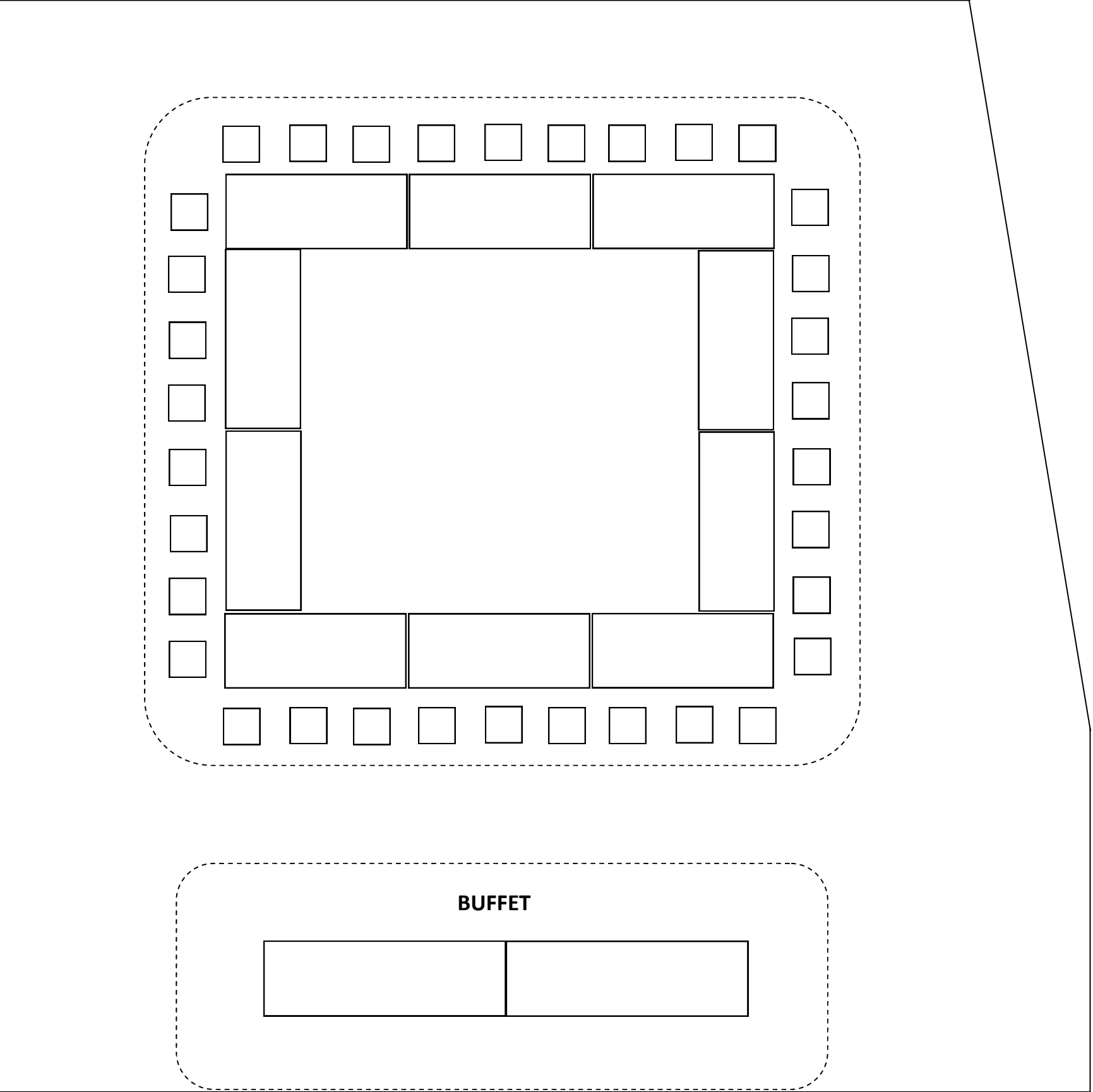

**LOWER HALL**  
**LARGE MEETING**

Audience:  
**SEATS 34-40**

- Required:**
- 10 - 30 x 72” tables
  - 34-40 blue cushion seats
  - 2 - 30 x 96” buffet tables

**LOWER HALL**  
**MEDIUM-SIZED MEETING**

SEATS 28-32

**Required:**

- 8 - 30 x 72” tables
- 28-32 blue cushion seats
- 2 - 30 x 96” buffet tables

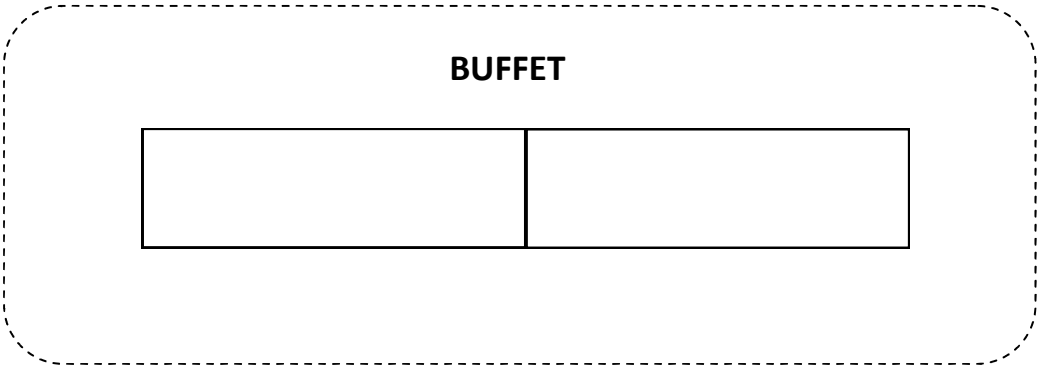
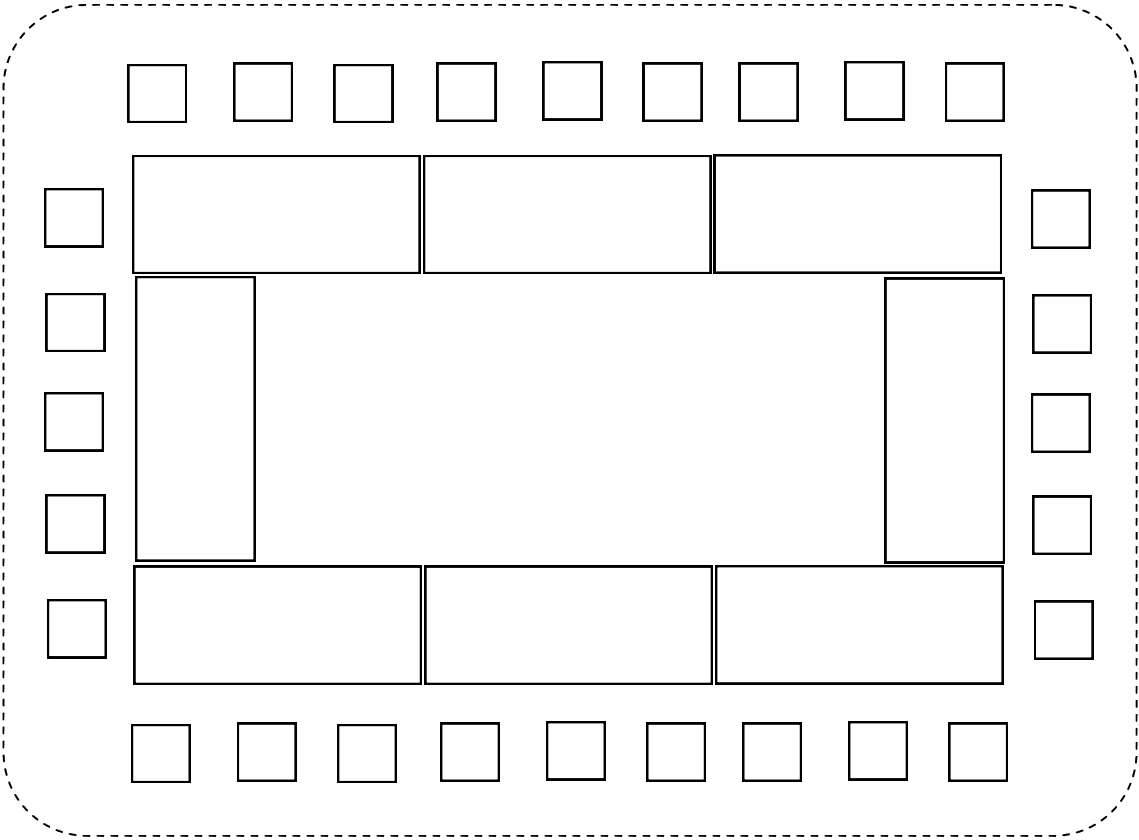

**UPPER HALL**  
**FORMAL DINING**  
**(MAX SEATING)**

SEATS 24

**Required:**

4 - 30 x 72" tables  
24 blue cushion seats

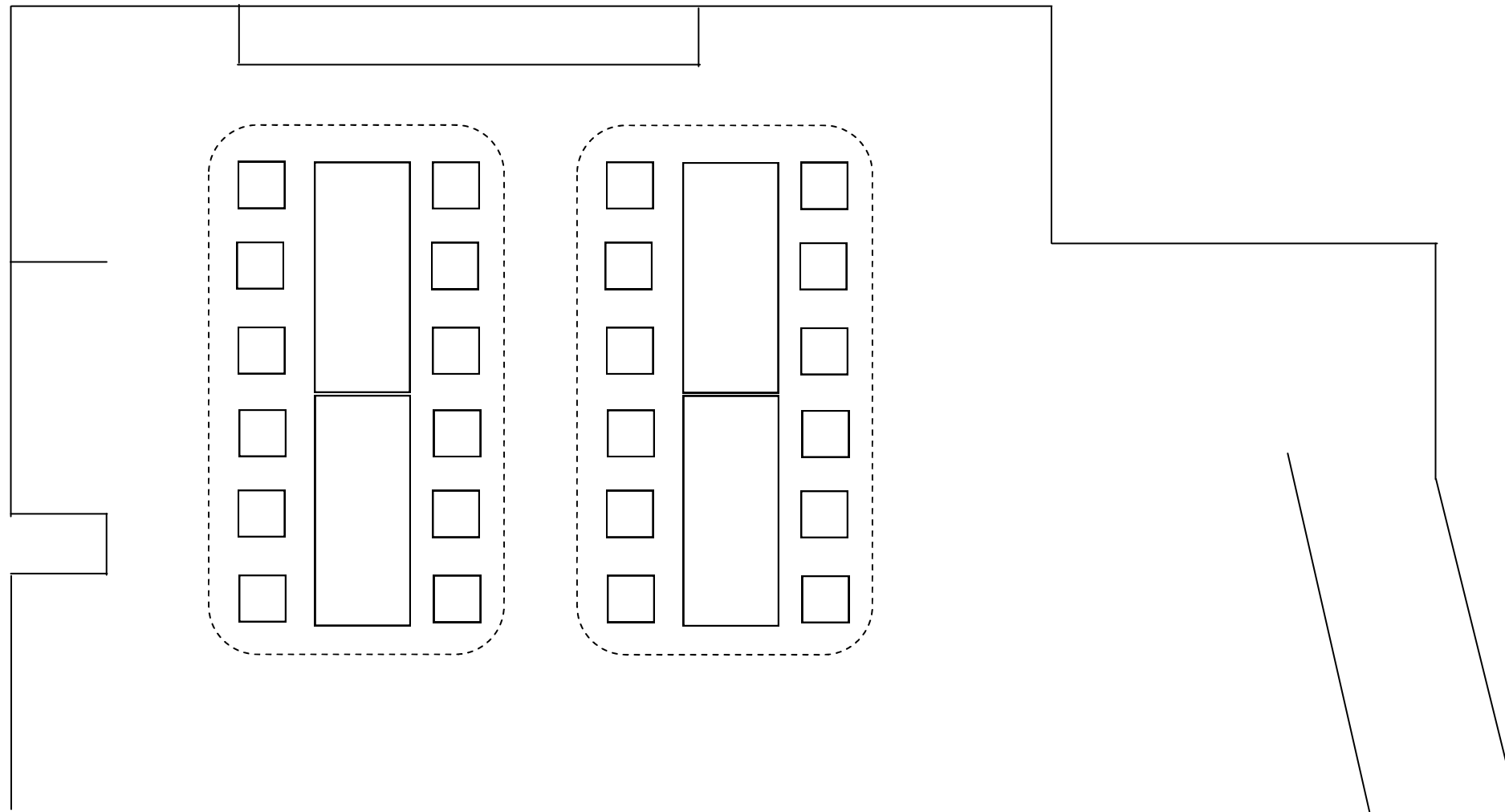

**UPPER HALL**  
**FORMAL DINING/  
SMALL GROUP MEETING  
(COMFORTABLE SEATING)**

**SEATS 14**

**Required:**

2 - 30 x 72" tables  
14 blue cushion seats

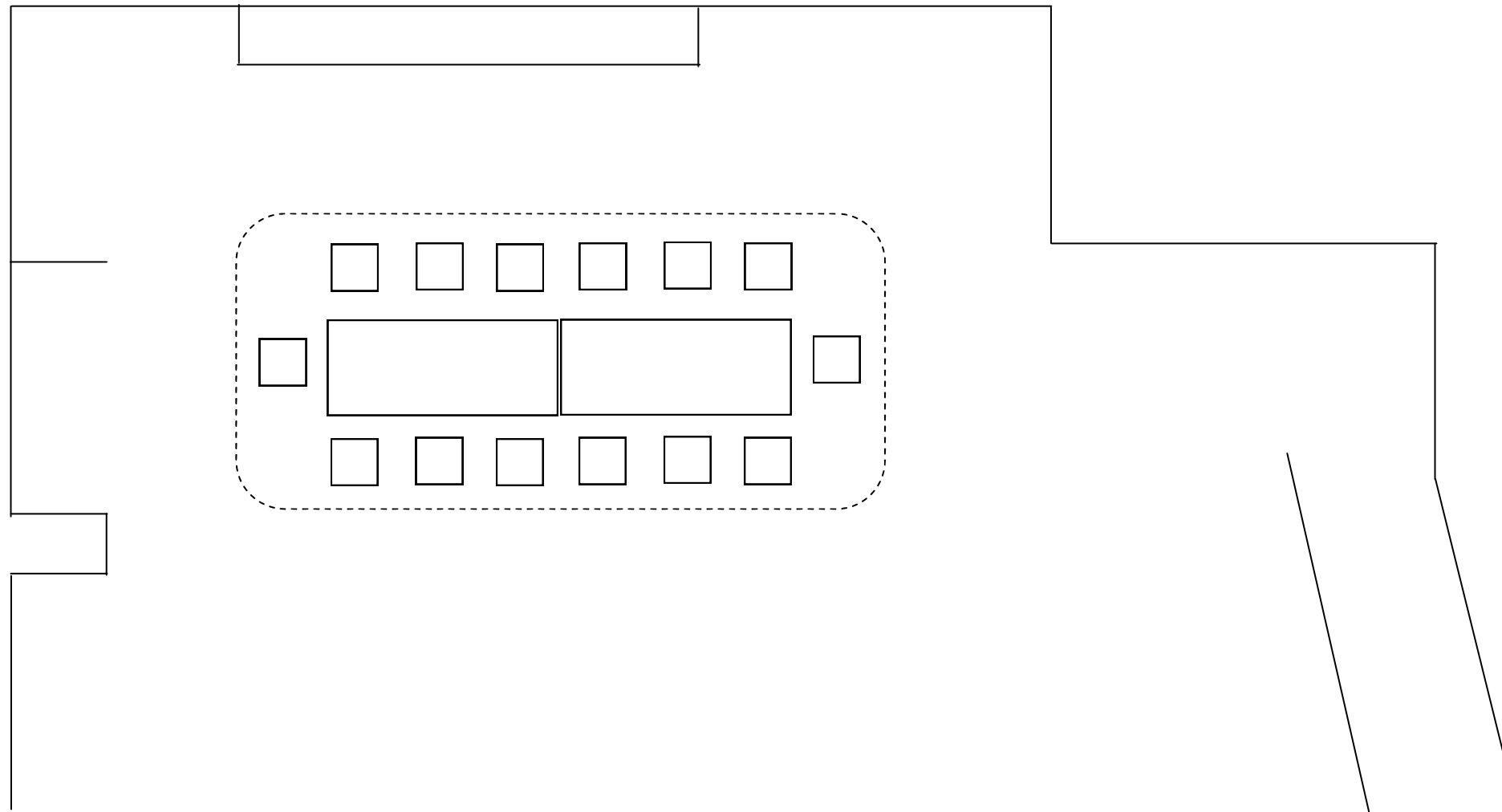

**UPPER HALL**  
**CASUAL DINING**

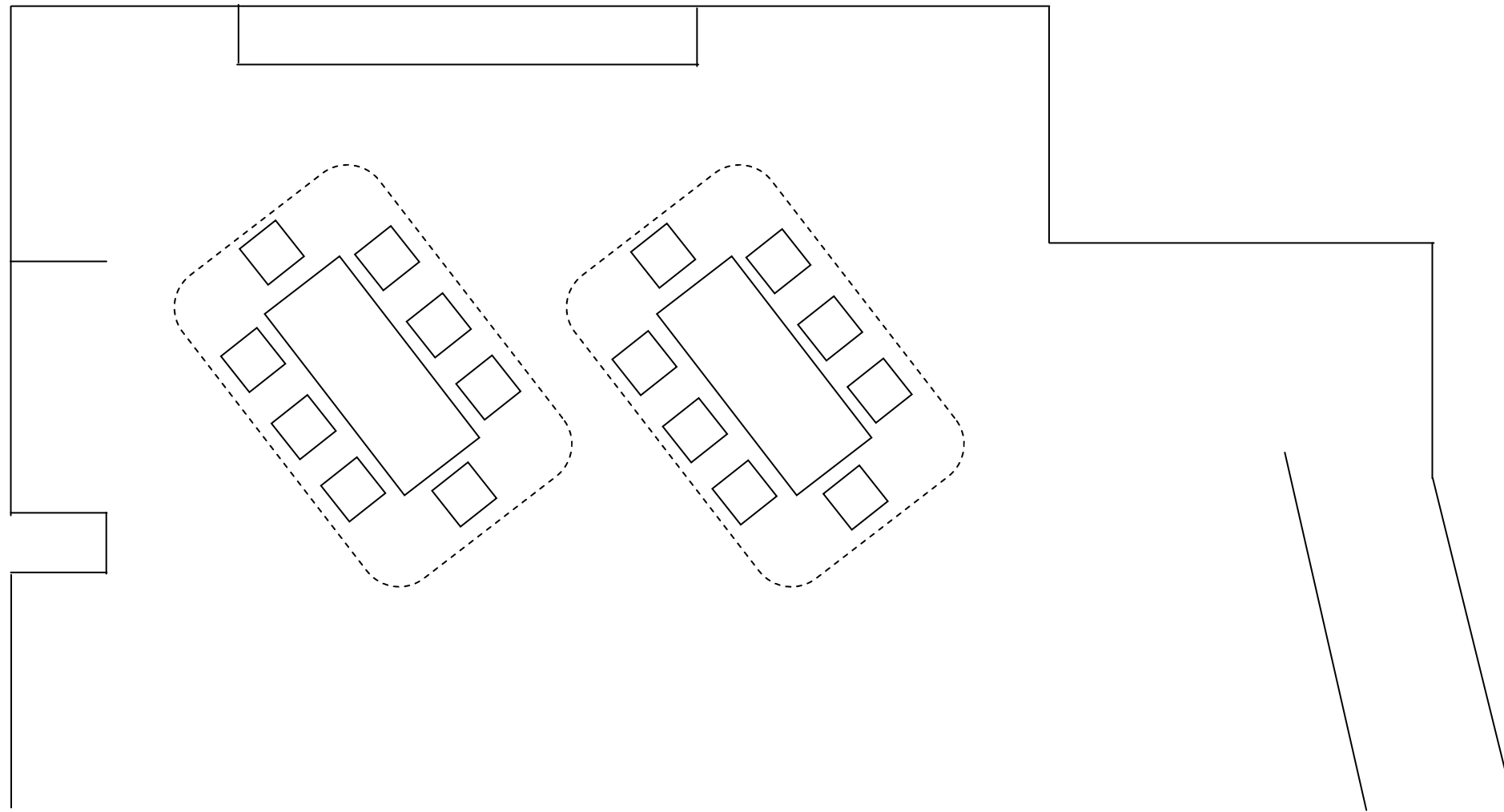

**SEATS 16**

**Required:**

2 - 30 x 72" tables  
16 blue cushion seats